

ZETA 120 max. 116 l/min - 31 GPM • 20 bar - 290 PSI • 550 RPM
ZETA 140 max. 135 l/min - 36 GPM • 20 bar - 290 PSI • 550 RPM

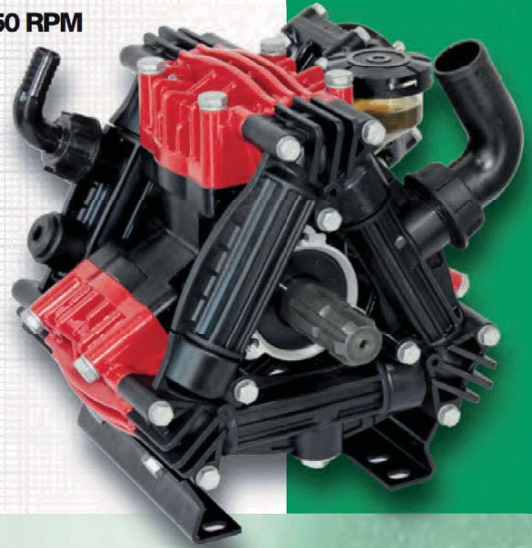

alberi P. di F. disponibili available P.T.O. shaft

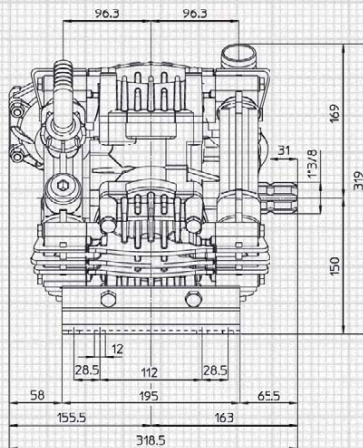
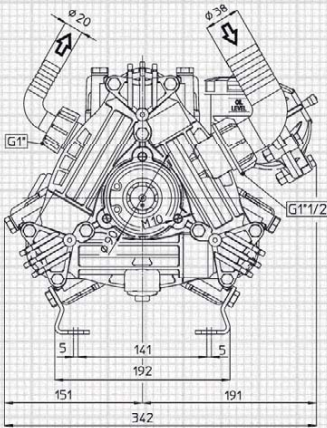

2-13



4-13-15

Solo/Only ZETA 120



13

Per le dimensioni degli Alberi P. di F. vedi pag. 35

For P.T.O. Shaft dimensions see page 35

applicazioni shaft adaptors

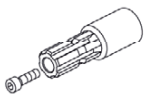

1

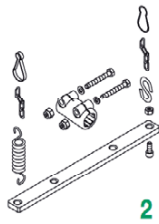

2

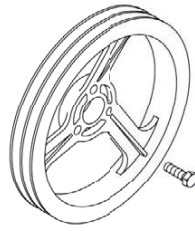

4



13

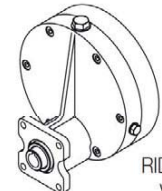

RIDUTTORI 15
Vedi pag. 42

GEAR REDUCTIONS 15
See page 42

MOD.	RPM	0 bar / 0 PSI				5 bar / 72 PSI				10 bar / 145 PSI				15 bar / 217 PSI				20 bar / 290 PSI				Peso Weight
		Portata Flow rate		Potenza Power		Portata Flow rate		Potenza Power		Portata Flow rate		Potenza Power		Portata Flow rate		Potenza Power		Portata Flow rate		Potenza Power		
		l/min	GPM	HP	kW	l/min	GPM	HP	kW	l/min	GPM	HP	kW	l/min	GPM	HP	kW	l/min	GPM	HP	kW	Kg
ZETA 120	400	86.9	23.0	0.9	0.6	83.7	22.1	1.1	0.8	82.8	21.9	2.1	1.6	82.2	21.7	3.2	2.3	81.9	21.6	4.2	3.1	18
	450	96.6	25.5	1.0	0.7	93.4	24.7	1.2	0.9	92.5	24.4	2.4	1.7	91.9	24.3	3.5	2.6	91.6	24.2	4.7	3.5	
	500	106.3	28.1	1.1	0.8	103.1	27.2	1.3	1.0	102.2	27.0	2.6	1.9	101.6	26.8	3.9	2.9	101.3	26.8	5.2	3.8	
	550	116.0	31.0	1.2	0.9	112.8	29.8	1.4	1.1	111.9	29.6	2.9	2.1	111.3	29.4	4.3	3.1	111.0	29.3	5.7	4.2	
ZETA 140	400	101.7	26.6	1.0	0.7	97.6	25.8	1.3	0.9	97.2	25.7	2.5	1.8	96.9	25.6	3.7	2.7	96.7	25.5	5.0	3.6	18
	450	119.8	31.4	1.2	0.9	108.7	28.7	1.4	1.0	108.3	28.6	2.8	2.0	108.0	28.5	4.2	3.1	107.8	28.5	5.5	4.1	
	500	123.9	32.5	1.2	0.9	119.8	31.7	1.5	1.1	119.4	31.5	3.1	2.3	119.1	31.5	4.6	3.4	118.9	31.4	6.1	4.5	
	550	135.0	36.0	1.3	1.0	130.9	34.6	1.7	1.2	130.5	34.5	3.3	2.5	130.2	34.4	5.0	3.7	130.0	34.3	6.7	4.9	